

NATURE

The NATURE Vanity range from Mode is made from TIMBER VENEER which is real timber, sliced finely and pressed onto HMR (Highly Moisture Resistant) board. This is the most cost effective and sustainable way to incorporate real wood into any design project.

Timber Veneer is 100% natural and so the pattern and grain aren't altered in any way and because only a thin slice is used it is more environmentally friendly using less of a precious resource. In contrast to solid timber, Timber Veneer will not expand and contract due to the variations in temperature or humidity in a bathroom environment.

Features

- Cabinet available in 4 x Timber Veneer Finishes (see below) with Finger Pull handles.
- Luxurious All Black Interior including Matt Black soft close drawers with full extension runners.
- 15 Year Warranty on Cabinetry.
- LED Drawer Lights with Motion Sensor in All Drawers (operate in low light).
- 2 Drawer Dividers in Top Drawers.
- Choice of Caesarstone, Evostone, Corian or matching Solid Timber Bench Tops with Basins included.
- 100% Australian Made Cabinetry with sizing from 750mm to 1800mm with custom sizes also available.
- Matching Shaving Cabinets and Tall Boys available.
- Wall Hung & Floor Standing models available.

For Drawings and Pricing see page 44 - 45



Nature 1200 Wall Hung Cabinet in Tasmanian Blackwood Timber Veneer with Finger Pull handles. Shown with Solid Timber Top in Tasmanian Blackwood with an Essence 480 Gloss White Basin.

Vanity including Basin \$4460.



Nature 900 Wall Hung Cabinet in Blackbutt Timber Veneer with Finger Pull handles. Shown with Solid Timber Top in Blackbutt with an Essence 400 Gloss White Basin and matching Paris 900 Mirrored Shaving Cabinet above.

**Vanity including Basin \$3853,
Shaving Cabinet with matching Black interior \$1028.**



Blackbutt

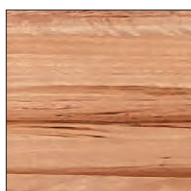

Messmate

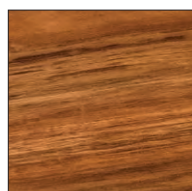

Tasmanian Blackwood

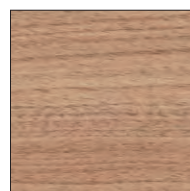

Tasmanian Oak



Nature 900 Floor Standing Cabinet in Messmate Timber Veneer with Finger Pull handles. Shown with Caesarstone top in White Attica with Cirque 360 Matt Black Basin and a Round 800mm LED Mirror above. Vanity including Basin \$3591, LED Mirror \$619.

750mm - WALL HUNG

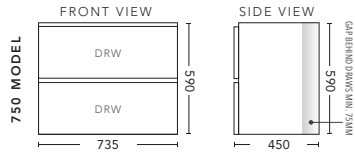

TIMBER VENEER CABINET WITH	PRODUCT CODE	RRP
Oxford Ceramic Top, Rectangular Bowl	NTV750XW	\$2,593
Elite Polymarble Top, Rectangular Bowl	NTV75ELW	\$2,593
Premier Polymarble Top, Oval Bowl	NTV75PRW	\$2,593
20mm Caesarstone Top with Ceramic Above Counter Basin	NTV75CSW	\$3,165
20mm Evostone Top with Ceramic Above Counter Basin	NTV75EVW	\$3,165
12mm Corian Top with Ceramic Above Counter Basin	NTV75COW	\$3,165
33mm Solid Timber Top with Ceramic Above Counter Basin	NTV75STW	\$3,535
No Top	NTV75W	\$2,378

750mm - FLOOR STANDING

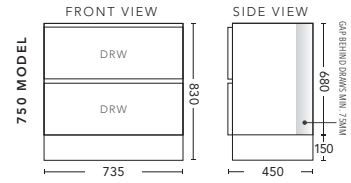

TIMBER VENEER CABINET WITH	PRODUCT CODE	RRP
Oxford Ceramic Top, Rectangular Bowl	NTV750XF	\$2,716
Elite Polymarble Top, Rectangular Bowl	NTV75ELF	\$2,716
Premier Polymarble Top, Oval Bowl	NTV75PRF	\$2,716
20mm Caesarstone Top with Ceramic Above Counter Basin	NTV75CSF	\$3,316
20mm Evostone Top with Ceramic Above Counter Basin	NTV75EVF	\$3,316
12mm Corian Top with Ceramic Above Counter Basin	NTV75COF	\$3,316
33mm Solid Timber Top with Ceramic Above Counter Basin	NTV75STF	\$3,703
No Top	NTV75F	\$2,492
*Smart Drawer Option (Requires 240mm Kicker) ADD	NTV75SD	\$403

900mm - WALL HUNG

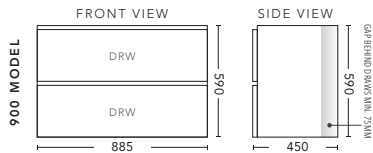

TIMBER VENEER CABINET WITH	PRODUCT CODE	RRP
Oxford Ceramic Top, Rectangular Bowl	NTV900XW	\$2,851
Elite Polymarble Top, Rectangular Bowl	NTV90ELW	\$2,851
Premier Polymarble Top, Oval Bowl	NTV90PRW	\$2,851
20mm Caesarstone Top with Ceramic Above Counter Basin	NTV90CSW	\$3,428
20mm Evostone Top with Ceramic Above Counter Basin	NTV90EVW	\$3,428
12mm Corian Top with Ceramic Above Counter Basin	NTV90COW	\$3,428
33mm Solid Timber Top with Ceramic Above Counter Basin	NTV90STW	\$3,853
No Top	NTV90W	\$2,526

900mm - FLOOR STANDING

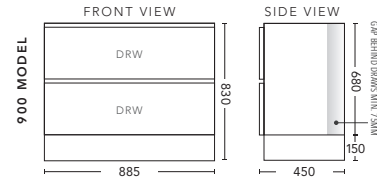

TIMBER VENEER CABINET WITH	PRODUCT CODE	RRP
Oxford Ceramic Top, Rectangular Bowl	NTV900XF	\$2,986
Elite Polymarble Top, Rectangular Bowl	NTV90ELF	\$2,986
Premier Polymarble Top, Oval Bowl	NTV90PRF	\$2,986
20mm Caesarstone Top with Ceramic Above Counter Basin	NTV90CSF	\$3,591
20mm Evostone Top with Ceramic Above Counter Basin	NTV90EVF	\$3,591
12mm Corian Top with Ceramic Above Counter Basin	NTV90COF	\$3,591
33mm Solid Timber Top with Ceramic Above Counter Basin	NTV90STF	\$4,036
No Top	NTV90F	\$2,647
*Smart Drawer Option (Requires 240mm Kicker) ADD	NTV90SD	\$403

1200mm - WALL HUNG

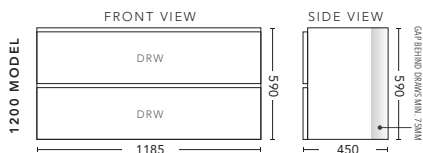

TIMBER VENEER CABINET WITH	PRODUCT CODE	RRP
Oxford Ceramic Top, Rectangular Bowl	NTV120XW	\$3,490
Elite Polymarble Top, Rectangular Bowl	NTV12ELW	\$3,490
Premier Polymarble Top, Oval Bowl	NTV12PRW	\$3,490
20mm Caesarstone Top with Ceramic Above Counter Basin	NTV12CSW	\$4,068
20mm Evostone Top with Ceramic Above Counter Basin	NTV12EVW	\$4,068
12mm Corian Top with Ceramic Above Counter Basin	NTV12COW	\$4,068
33mm Solid Timber Top with Ceramic Above Counter Basin	NTV12STW	\$4,460
No Top	NTV12W	\$2,977

1200mm - FLOOR STANDING

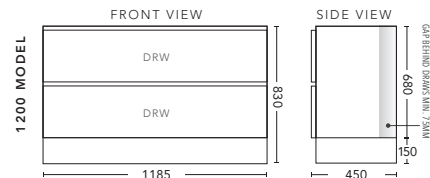

TIMBER VENEER CABINET WITH	PRODUCT CODE	RRP
Oxford Ceramic Top, Rectangular Bowl	NTV120XF	\$3,656
Elite Polymarble Top, Rectangular Bowl	NTV12ELF	\$3,656
Premier Polymarble Top, Oval Bowl	NTV12PRF	\$3,656
20mm Caesarstone Top with Ceramic Above Counter Basin	NTV12CSF	\$4,262
20mm Evostone Top with Ceramic Above Counter Basin	NTV12EVF	\$4,262
12mm Corian Top with Ceramic Above Counter Basin	NTV12COF	\$4,262
33mm Solid Timber Top with Ceramic Above Counter Basin	NTV12STF	\$4,673
No Top	NTV12F	\$3,119
*Smart Drawer Option (Requires 240mm Kicker) ADD	NTV12SD	\$403

1500mm Single Bowl - WALL HUNG

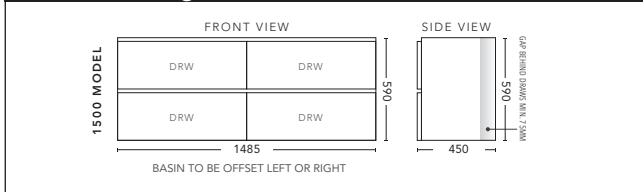

TIMBER VENEER CABINET WITH	PRODUCT CODE	RRP
Elite Polymarble Top, Rectangular Bowl	NTV151ELW	\$4,330
20mm Caesarstone Top with Ceramic Above Counter Basin	NTV151CSW	\$4,871
20mm Evostone Top with Ceramic Above Counter Basin	NTV151EVW	\$4,871
12mm Corian Top with Ceramic Above Counter Basin	NTV151COW	\$4,871
33mm Solid Timber Top with Ceramic Above Counter Basin	NTV151STW	\$5,292
No Top	NTV151W	\$3,283

1500mm Single Bowl - FLOOR STANDING

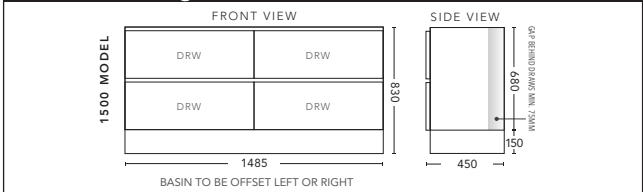

TIMBER VENEER CABINET WITH	PRODUCT CODE	RRP
Elite Polymarble Top, Rectangular Bowl	NTV151ELF	\$4,536
20mm Caesarstone Top with Ceramic Above Counter Basin	NTV151CSF	\$5,103
20mm Evostone Top with Ceramic Above Counter Basin	NTV151EVF	\$5,103
12mm Corian Top with Ceramic Above Counter Basin	NTV151COF	\$5,103
33mm Solid Timber Top with Ceramic Above Counter Basin	NTV151STF	\$5,544
No Top	NTV151F	\$3,440
*Smart Drawer Option (Requires 240mm Kicker) ADD	NTV151SD	\$632

1500mm Double Bowl - WALL HUNG

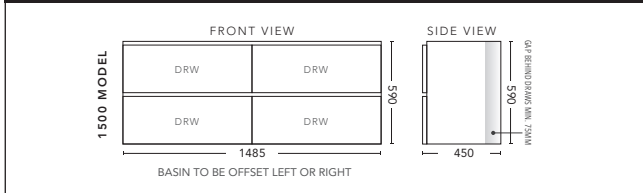

TIMBER VENEER CABINET WITH	PRODUCT CODE	RRP
Elite Polymarble Top, Rectangular Bowl	NTV152ELW	\$4,330
Premier Polymarble Top, Oval Bowl	NTV152PRW	\$4,330
20mm Caesarstone Top with Ceramic Above Counter Basin	NTV152CSW	\$4,871
20mm Evostone Top with Ceramic Above Counter Basin	NTV152EVW	\$4,871
12mm Corian Top with Ceramic Above Counter Basin	NTV152COW	\$4,871
33mm Solid Timber Top with Ceramic Above Counter Basin	NTV152STW	\$5,292
No Top	NTV152W	\$3,283

1500mm Double Bowl - FLOOR STANDING

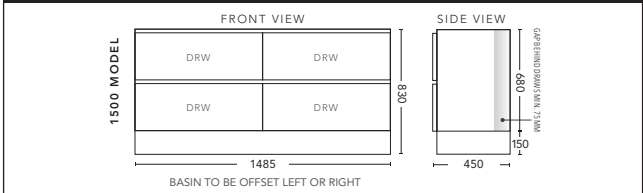

TIMBER VENEER CABINET WITH	PRODUCT CODE	RRP
Elite Polymarble Top, Rectangular Bowl	NTV152ELF	\$4,536
Premier Polymarble Top, Oval Bowl	NTV152PRF	\$4,536
20mm Caesarstone Top with Ceramic Above Counter Basin	NTV152CSF	\$5,103
20mm Evostone Top with Ceramic Above Counter Basin	NTV152EVF	\$5,103
12mm Corian Top with Ceramic Above Counter Basin	NTV152COF	\$5,103
33mm Solid Timber Top with Ceramic Above Counter Basin	NTV152STF	\$5,544
No Top	NTV152F	\$3,440
*Smart Drawer Option (Requires 240mm Kicker) ADD	NTV152SD	\$632

1800mm Single Bowl - WALL HUNG

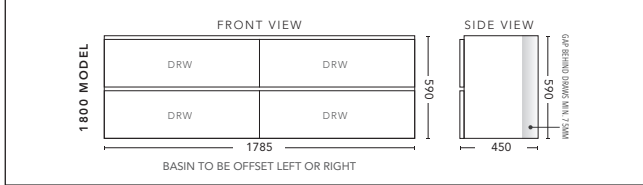

TIMBER VENEER CABINET WITH	PRODUCT CODE	RRP
Elite Polymarble Top, Rectangular Bowl	NTV181ELW	\$5,161
20mm Caesarstone Top with Ceramic Above Counter Basin	NTV181CSW	\$5,753
20mm Evostone Top with Ceramic Above Counter Basin	NTV181EVW	\$5,753
12mm Corian Top with Ceramic Above Counter Basin	NTV181COW	\$5,753
33mm Solid Timber Top with Ceramic Above Counter Basin	NTV181STW	\$6,349
No Top	NTV181W	\$3,834

1800mm Single Bowl - FLOOR STANDING

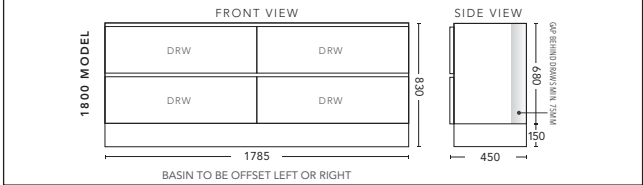

TIMBER VENEER CABINET WITH	PRODUCT CODE	RRP
Elite Polymarble Top, Rectangular Bowl	NTV181ELF	\$5,406
20mm Caesarstone Top with Ceramic Above Counter Basin	NTV181CSF	\$6,027
20mm Evostone Top with Ceramic Above Counter Basin	NTV181EVF	\$6,027
12mm Corian Top with Ceramic Above Counter Basin	NTV181COF	\$6,027
33mm Solid Timber Top with Ceramic Above Counter Basin	NTV181STF	\$6,652
No Top	NTV181F	\$4,017
*Smart Drawer Option (Requires 240mm Kicker) ADD	NTV181SD	\$632

1800mm Double Bowl - WALL HUNG

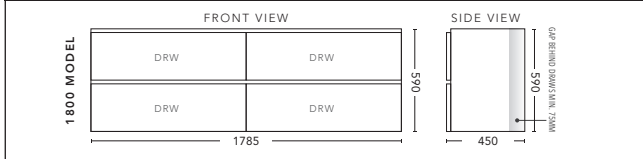

TIMBER VENEER CABINET WITH	PRODUCT CODE	RRP
Elite Polymarble Top, Rectangular Bowl	NTV182ELW	\$5,161
20mm Caesarstone Top with Ceramic Above Counter Basin	NTV182CSW	\$5,753
20mm Evostone Top with Ceramic Above Counter Basin	NTV182EVW	\$5,753
12mm Corian Top with Ceramic Above Counter Basin	NTV182COW	\$5,753
33mm Solid Timber Top with Ceramic Above Counter Basin	NTV182STW	\$6,349
No Top	NTV182W	\$3,834

1800mm Double Bowl - FLOOR STANDING

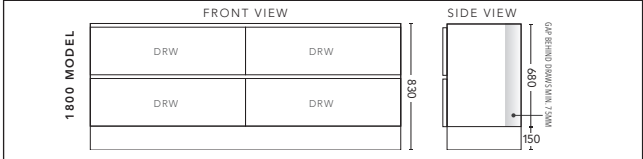

TIMBER VENEER CABINET WITH	PRODUCT CODE	RRP
Elite Polymarble Top, Rectangular Bowl	NTV182ELF	\$5,406
20mm Caesarstone Top with Ceramic Above Counter Basin	NTV182CSF	\$6,027
20mm Evostone Top with Ceramic Above Counter Basin	NTV182EVF	\$6,027
12mm Corian Top with Ceramic Above Counter Basin	NTV182COF	\$6,027
33mm Solid Timber Top with Ceramic Above Counter Basin	NTV182STF	\$6,652
No Top	NTV182F	\$4,017
*Smart Drawer Option (Requires 240mm Kicker) ADD	NTV182SD	\$632